



## Sylvan Avenue

**£475,000**

Situated on a tree-lined road within a stones throw of Mill Hill Broadway is this well proportioned 2 double bedroom first floor flat with a private entrance, private rear garden and in need of modernisation. The property boasts a bright and airy kitchen, large living room, 2 double bedrooms ( one with a balcony) a family bathroom and separate W/C. Further benefits include a private rear garden, garage and ample storage. Long Lease, Viewing Highly Recommended. Sole Agent.

### Viewing

Please contact our Mill Hill Office on 020 8959 0011 if you wish to arrange a viewing appointment for this property or require further information.



2



1



1



## Floor Plan

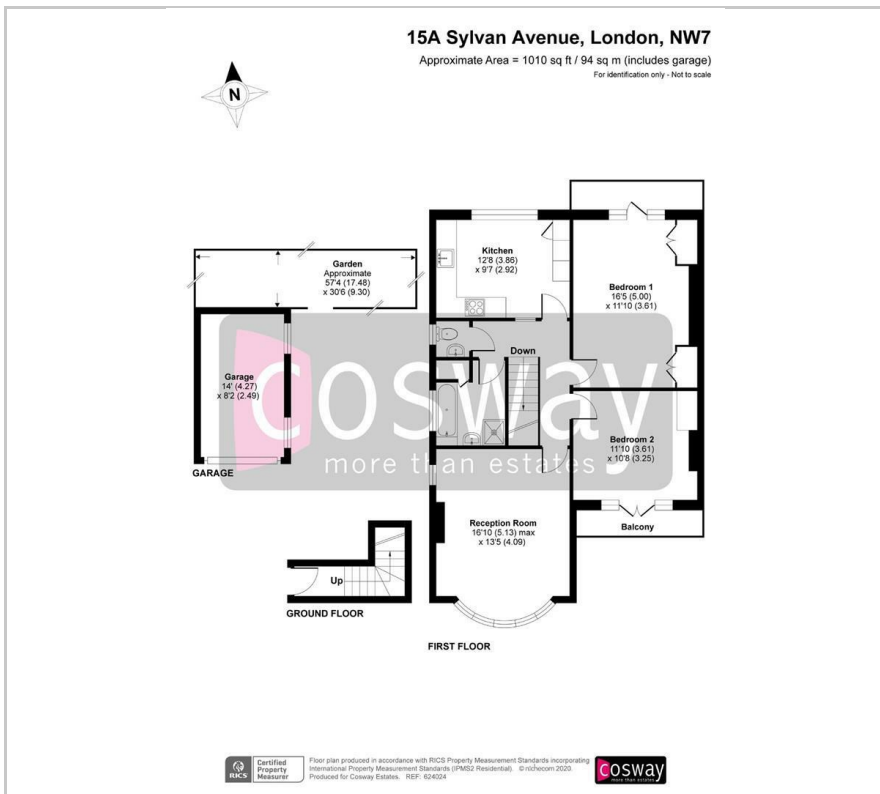

## Area Map



## Energy Efficiency Graph

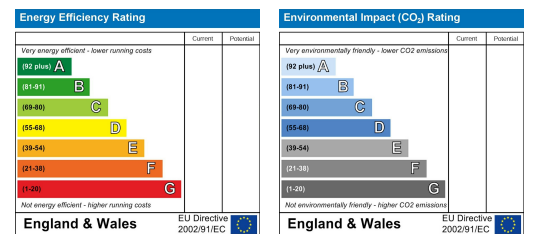

These particulars, whilst believed to be accurate are set out as a general outline only for guidance and do not constitute any part of an offer or contract. Intending purchasers should not rely on them as statements of representation of fact, but must satisfy themselves by inspection or otherwise as to their accuracy. No person in this firm's employment has the authority to make or give any representation or warranty in respect of the property.